



Cat. No.  
K-1



Cat. No.  
K-12



Cat. No.  
K-25R25

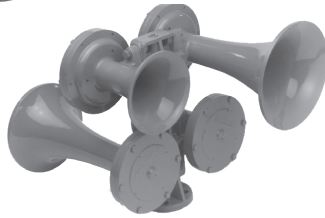

## Airchime® Air Horns

### Single or Dual Tone

### K Series

The K series is designed for general signaling services. They generate sound by means of a vibrating diaphragm that modulates the flow of compressed air into a resonating projector. All horn shapes are mathematically calculated to amplify sound while closely retaining its fundamental frequency and natural harmonics.

These horns can be used for indoor/outdoor applications and are ideal for hazardous location use. Volume is adjustable by regulating air pressure.

Designed for mounting on air supply piping, supplying between 50 and 150 PSIG (3.5 and 10.5 kg/sq cm).

Typical applications include emergency signaling applications in mines, refineries and industrial facilities. Ideal for individual equipment and plant warnings.

#### FEATURES

- > Die cast aluminum construction
- > Adjust volume via air pressure
- > Hermetically sealed diaphragm
- > Effect. range - 3/4 mile (1.2 km)\*

#### SPECIFICATIONS

- > .5 - 2 cu ft /sec (14.2 - 5.6 liters/sec)
- > Operating range - 50 to 150 PSIG (3.5 to 10.5 kg/sq cm)

Cat. No.	Description	Freq. (Hz)	dB(c) at 10 ft.	dB(c) at 100 ft.	Air Consumption		Inlet NPT	Length	Net Weight lbs. (kg)
					Cu. Ft. /Sec. (Liters/Sec.)				
K-1	Single tone, cast base, die cast aluminum body, 3 piece hermetically sealed stainless steel diaphragm	311	134	114	.50 (14)		1/2" (13mm)	16 1/2" (419mm)	7 1/2 (3.4)
K-2	Same as above	370	130	110	.50 (14)		1/2" (13mm)	12 7/8" (327mm)	6 1/2 (2.9)
K-3	Same as above	470	133	113	.50 (14)		1/2" (13mm)	10 1/4" (260mm)	6 1/4 (2.8)
K-5	Same as above	622	132	112	.50 (14)		1/2" (13mm)	7 1/2" (191mm)	5 (2.2)
K-12	Dual tone incorporating K1 & K2 with base	311/370	134	114	1 (28)		1/2" (13mm)	16 1/2" (419mm)	14 1/2 (6.5)
K-25	Dual tone incorporating K2 & K5 with base	370/622	135	115	1 (28)		1/2" (13mm)	12 7/8" (327mm)	12 (5.4)
K-12R12	Dual tone incorporating 2 K-12 Air Horns reversed for 180° coverage with base	311/370	135	115	2 (56)		3/4" (19mm)	16 1/2" (419mm)	24 1/2 (11.1)
K-25R25	Dual tone incorporating 2 K-25 Air Horns reversed for 180° coverage with base	370/622	136	116	2 (56)		3/4" (19mm)	12 7/8" (327mm)	55 (24.9)

\* Subject to environmental and geographical conditions, these models have a typical effective range of 3/4 mile (1.2 km) assuming an ambient background level of 60dB, a line pressure of 100 psi (7.03 kg/sq cm) and temperature of 60°F (15.6°C). Derated per FEMA guidelines @ 10 dB per distance doubled.

D-04